

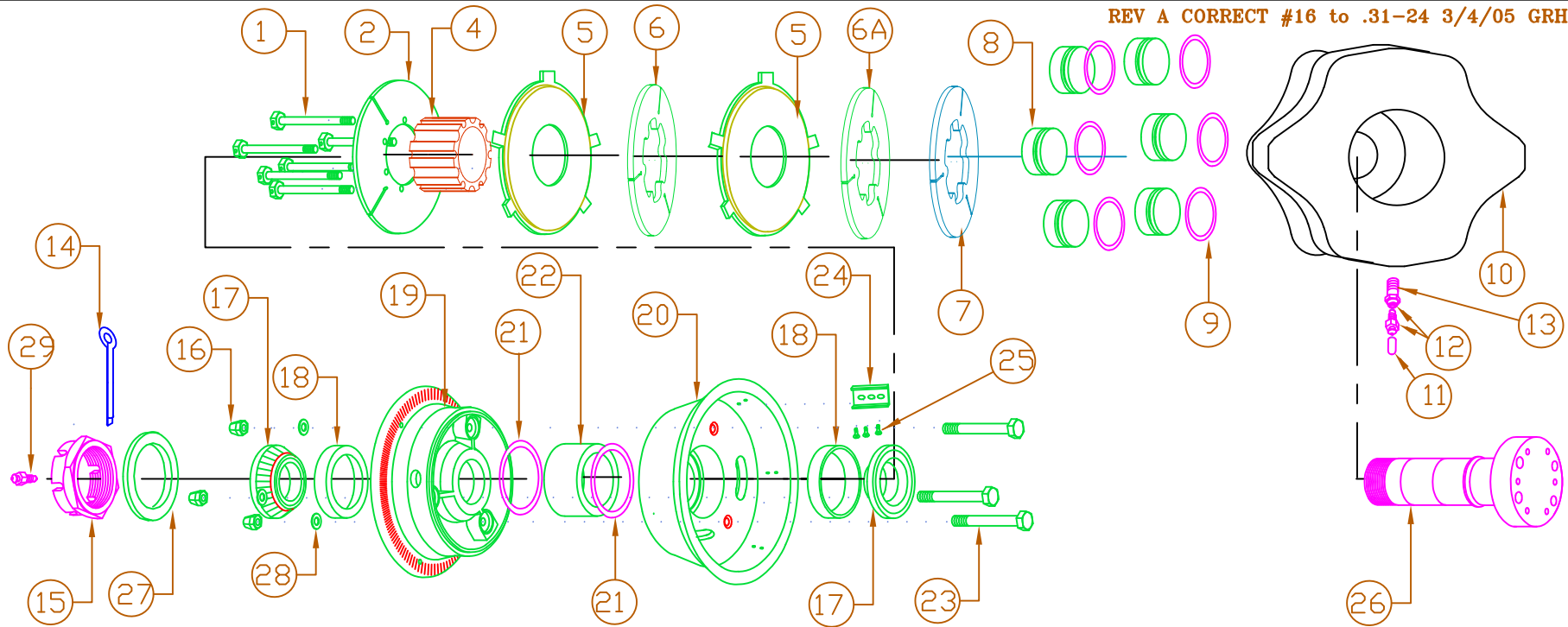

REV A CORRECT #16 to .31-24 3/4/05 GRH



NO.	PART NAME	INVENTORY NO.	REQ'D
1	BOLT, DRILLED	MSCAN4C-24	6
2	STATOR, BACK PLATE	WHLDS323AS-1	1
3	LEFT BLANK		
4	TUBE, TORQUE	WHLTT323S	1
5	ROTOR	WHLDR323	2
6	STATOR, RADIUS DRIVE	WHLDS323AS-2	1
6A	STATOR, PRES PLATE RADIUS DRIVE	WHLDS323AS-3	1
7	INSULATOR, RADIUS DRIVE	WHLDI323AS	1
8	PISTON, W323	WHLPI-323	6
9	O-RING BUNA N	MSC2-210	6

NO.	PART NAME	INVENTORY NO.	REQ'D	NO.	PART NAME	INVENTORY NO.	REQ'D
14	COTTER PIN ZINC	.125X2.0COTTERPIN	1	23	BOLT, SH FLAT	MSCAN5C-25A	3
15	AXLE NUT, 1.50X16 SHORT	AN6S	1	24	KEY, WHEEL	WHLK323S	5
16	FLEX LOCK NUT SS, .31-24 (TORQUE 125 IN. LBS)	AN363C-524	3	25	SCREW, FLT HD	MSC8-32X.3125	15
17	ROLLER BEARING, 1.50	LM2900LA	2	26	AXLE, 1.5 X6.5, W323	WHLA15M	1
18	BEARING RACE, 1.50	LM29710	2	27	WASHER	MSCTRA2435	1
19	VALVE HALF, W323S, 1.50 BRNG	W323S/1.50	1	28	WASHER	MSCAN960C-516L	3
20	BRAKE HALF, W323S, 1.50 BRNG	B323S/1.50	1	29	FITTING, GREASE	MSC11-151	1
21	O-RING BUNA N	MSC2-138	2				
22	SLEEVE, GREASE	WHLPVC-323	1				

MATCO mfg  (801) 335-0582
 2361 S 1560 West WOODS CROSS, UT 84087

DRAWING TITLE: W323AS
 FILE NAME: 3D-W323AS

DRW. BY: G HAPP SCALE:
 DATE: JUNE 12, 2001 CK. BY: SHEET# 1 OF 1 REVISION A