

Release Pin Engage at 35 deg. Full Release
at 40 deg.
Alternate Arm Available for Full Release at
25 deg.
Default attach hole 0.312. May open to
0.563

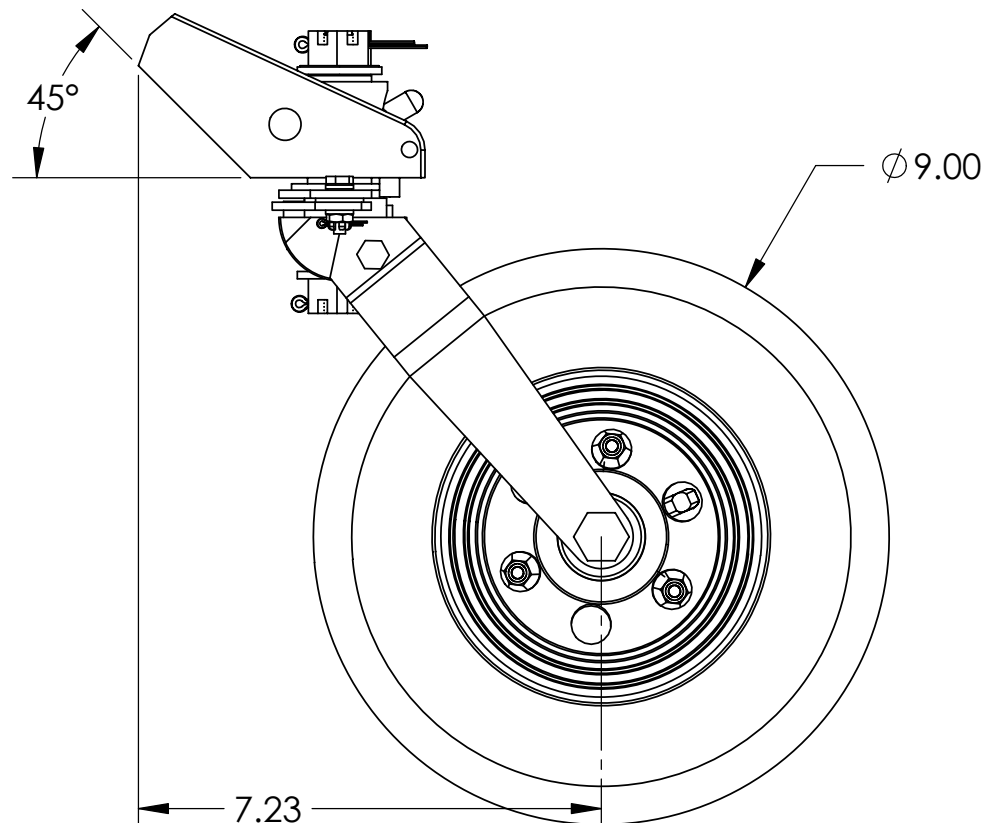
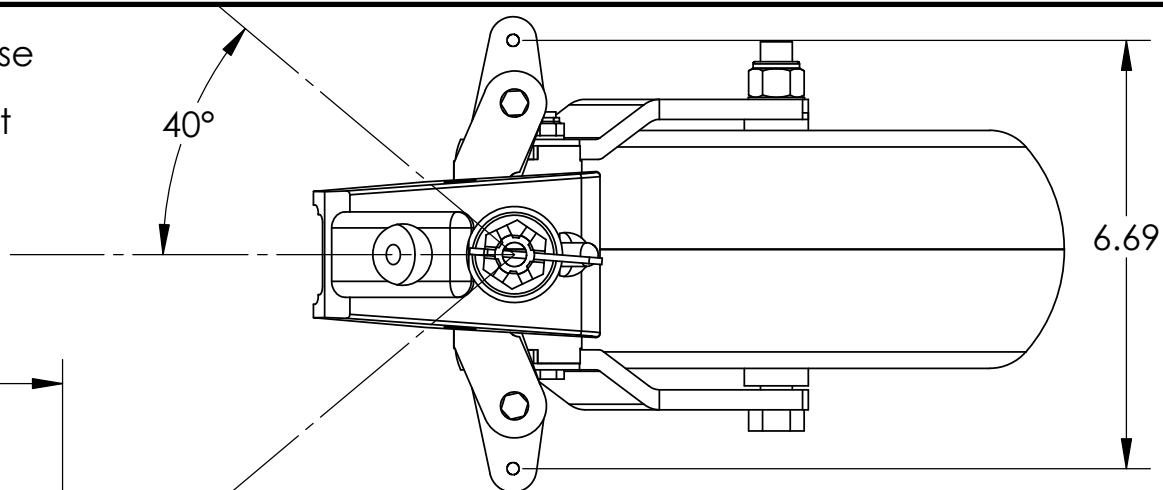
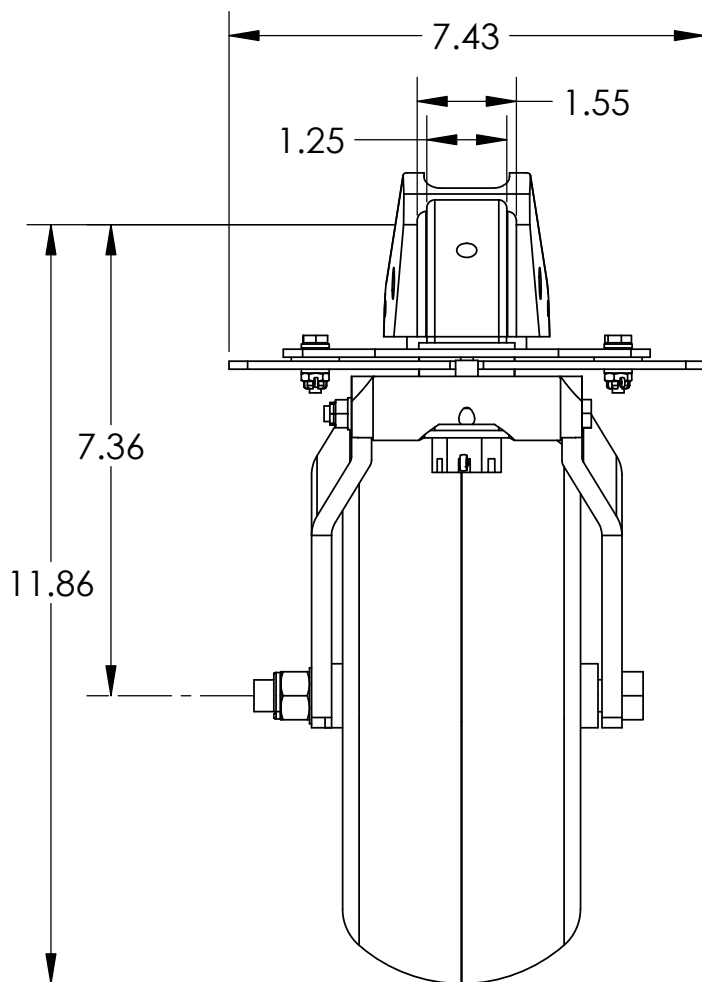

MATCO mfg

550W 3615 South
Salt Lake City, Utah 84115 USA

DRAWN BY
George R. Happ



NOMENCLATURE
TAILWHEEL, 8" DUAL FORK WIDE

MATERIAL
VARIES

DATE
3/21/2006

PART NUMBER
WHLT-8WD

DRAWING NO.
TAIL/T-8WD INSTALL

CHECKED BY

SHEET 1 OF 1
SHEET SIZE A

SCALE
1:3

Est Wt. (lb)
8.55

TOLERANCES
(EXCEPT AS NOTED)

DO NOT SCALE DRAWING
LINEAR .XX = + .03
.XXX = + .01
ANGULAR ± 1/2
CONCENTRIC ± .01