



2361 S 1560 West
Woods Cross, UT 84087
801-335-0582
801-335-0581 (F)

SERVICE BULLETIN

WHLT-8 & WHLT-6 Vertical Axle Preload Enhancement

A product improvement has been made to the WHLT-8 and WHLT-6 tail wheel assemblies to provide an easier method to set the preload torque in the vertical axle. This is accomplished by the use of new curved spring washers that are added to the upper portion of the vertical axle assembly. The upgrade kit, part number WHLT8CSK, can be obtained by calling MATCO mfg at the number above.

Please refer to the attached drawing and use the following procedure.

To Set Preload In Vertical Axle #1: With no load on tail wheel, remove cotter pin #2 from castle nut #3. Remove castle nut #3. Remove washer #5. Using the two curved spring washers (#4) from the upgrade kit, install one curved washer below and one curved washer above flat washer #5 as shown. Reinstall castle nut #3 and tighten slowly until all free play of springs #4 is removed and tail wheel fork #6 no longer rotates freely about vertical axle. Loosen castle nut #3 two to three locking features and install new cotter pin #2 from upgrade kit. Fork should pivot freely around complete rotation.

Questions regarding this bulletin can be referred to the technical support department of MATCO mfg at 550 West 3615 South, Salt Lake City, Utah 84115, by email to tech@matcomfg.com, or by telephoning (801) 486-7574.

SRV111805
18 November 2005
MATCO mfg

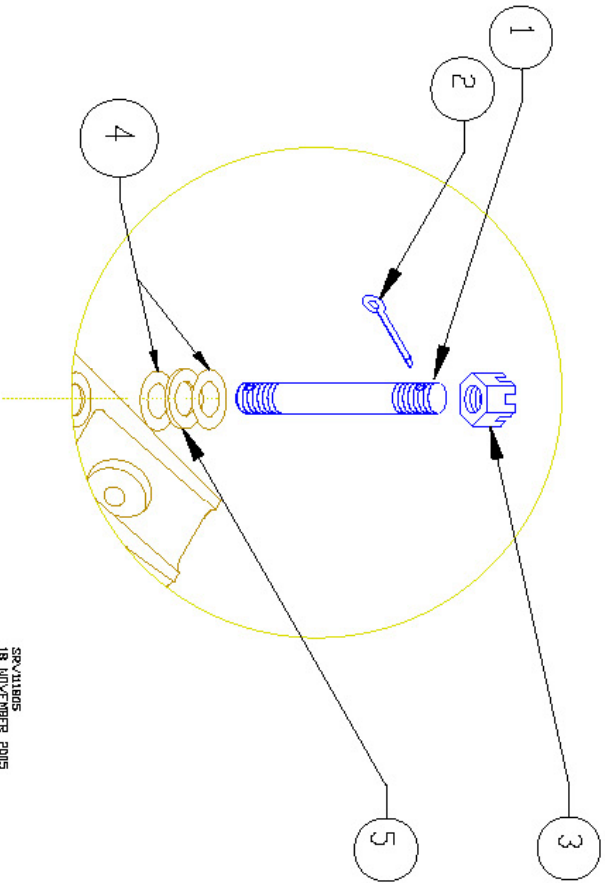
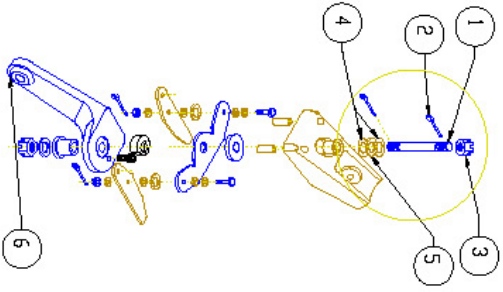

SPATIUMS
 18. NOVEMBER 2015
 MATCO mfg