

REV C CHANGE FILL to VENT ON #12 9-07-11 GRH
 REV D CORRECT #19 to 0.62 from 0.75 6-16-15 GRH

| NO. | INVENTORY NO. | PART NAME | REQ'D |
|-----|--------------------|-------------------|-------|
| 1 | MC7-L | ACTUATOR LEVER | 1 |
| 2 | MC7YOKE | CYLINDER YOKE | 1 |
| 3 | 3000-X75 | SNAP RING | 1 |
| 4 | 0600-0101-.375 | STAT-O-SEAL | 1 |
| 5 | MC7SL | SLEEVE | 1 |
| 6 | MC7-1 | SHAFT | 1 |
| 7 | 0600-0101-10 | STAT-O-SEAL | 1 |
| 8 | 2-112 | O-RING, PISTON | 1 |
| 9 | MC-16 | SPRING GUIDE | 1 |
| 10 | MSC0480-055-2250M | SPRING | 1 |
| 11 | MC7H | HOUSING | 1 |
| 12 | MC7-4 | VENT PORT | 1 |
| 13 | MCP.688(B) | PISTON | 1 |
| 14 | MSC.25-20X1.25SHSB | SHOULDER BOLT | 1 |
| 15 | MSC.25-20NYLOCK | NYLOCK NUT | 1 |
| 16 | MC7-PPIN | PIVOT PIN | 1 |
| 17 | 5100-25 | SNAP RING | 1 |
| 18 | MC6-2 | CLAMP | 1 |
| 19 | MSC10-24X.62SHCS | SOCKET HEAD SCREW | 2 |
| 20 | AN960-416L | WASHER | 2 |
| 21 | C0300-026-0440M | VALVE SPRING | 1 |
| 22 | 168P | STRAIGHT FITTING | 1 |
| 23 | VC-250-8 | DUST PLUG, BLACK | 1 |

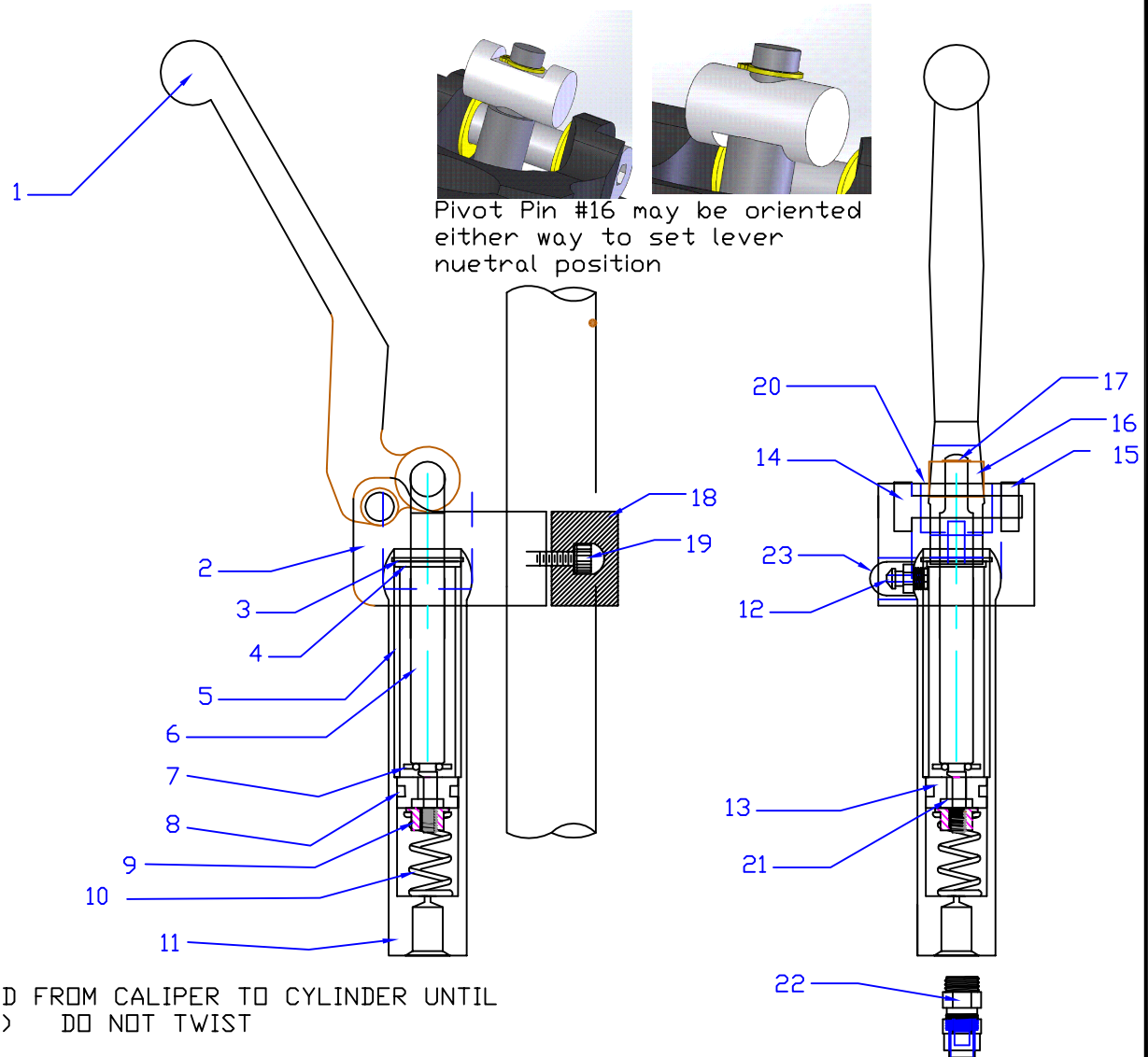

- FILL WITH MIL-H-5606 OR EQUIVALENT
 - INITIAL BLEED PERFORMED BY PUMPING FLUID FROM CALIPER TO CYLINDER UNTIL FLUID FLOWS FROM AIR FREE VERTICAL (#12) DO NOT TWIST
 - MOUNT UNIT WITH HANDLE VERTICAL

MATCOmfg
 2361 S 1560 West
 WOODS CROSS, UT 84087

NOMENCLATURE
 CYLINDER, HAND OPERATED MASTER

PART NUMBER
 MC-7

SCALE

TOLERANCES

MATERIAL

DRAWING NO.
 MASTER/MC7_INSTALL.DWG

REVISION
 D

(EXCEPT AS NOTED)
 DO NOT SCALE DRAWING
 LINEAR .XX = ±.03
 .XXX = ±.01
 ANGULAR ±1/2
 CONCENTRIC ±.01

DRAWN BY
 G. HAPP

FINISH
 NONE

DATE
 06/01/04

CHECKED BY
 SHEET 1 OF 1
 SHEET SIZE A