

ITEM #	Part Number	Description	QTY.
1	MSC.11x1.5COTTERPI	PIN, COTTER ZINC	2
2	MSC.62-18HEXNUT/SL	NUT, HEX SLOTTED	2
3	MSCU321608	WASHER, BELLEVILLE	1
4	MSC.625SAE	WASHER, 5/8	2
5	MSCU625-0210	WASHER, CURVED	1
6	MSC.62-18X4.35(A)	AXLE, VERTICAL TAILWHEEL	1
7	WHLTW-19	BUSHING, HAT	3
8	WHLTWBL	BASE, TAIL WHEEL	1
9	MSCVC-250-8	COVER, BLEEDER BLK	1
10	MSCMC7-4	FITTING, GREASE	1
11	WHLTW-4	WASHER, BRONZE	1
12	WHLBSP4	SPACER, 4"/UL BRAKE	2
13	MSC.0625X.50COTTER	PIN, COTTER ZINC	2
14	MSCAN310-3	NUT, CASTLE	2
16	MSC.25-20x.50SHCS	BOLT, SHCS .25-20X.50	1
17	MSCAN960-10	WASHER, THICK	4
18	WHLT-02	ARM, TAIL WHEEL	1
19	MSC.750x.190x.062W	WASHER, BRONZE	2
20	WHLT-03	Wing, Tail Wheel	2
21	MSCB0375-020	WASHER, BELLEVILLE	4
22	MSCAN3-6	BOLT, HEX DRILLED	2
23	WHLTW-8F	FORK, CANTILEVER 8"	1
24	MSC.50-13x3.50SHCS	SCREW, SOCKET HEAD	1
25	WHLT8SL	SPACER, T8SL	1
26	TIRT2.80/2.50-4	TIRE, 2.80/2.50-4	1
27	WHLTW40EE	ASSEMBLY, 4" TW	1
28	TIRTU2.80-4	TUBE, 2.80/2.50-4	1
29	MSCAN960-816L	WASHER	2
30	MSC.50-13NYLOCK	NUT, NYLOCK	1
31	WHLTW-21S	BUSHING, SLOTTED PIE SHAPED	1
32	MSC10-24x.50SHCS	SCREW, SOCKET HEAD	1

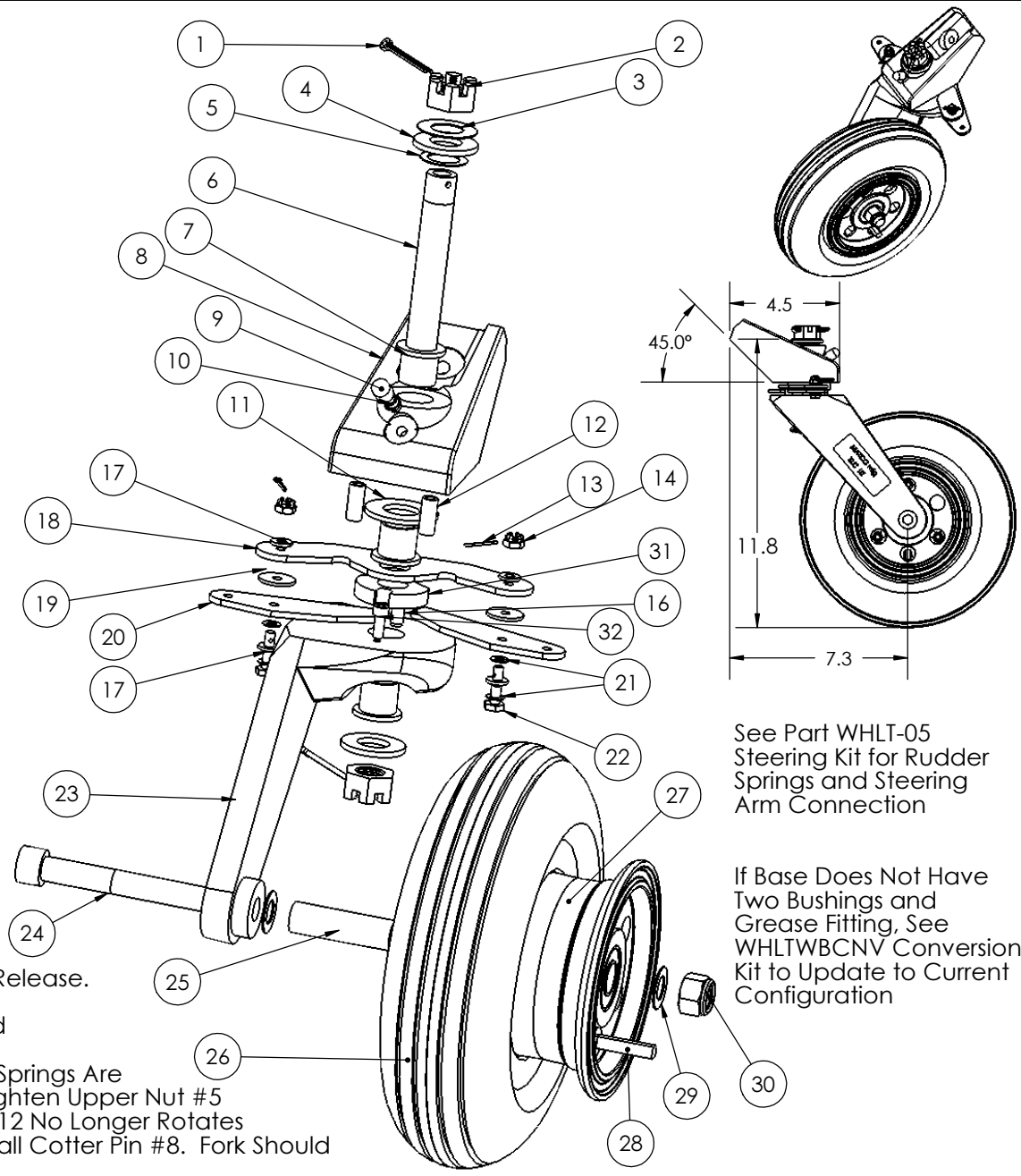

See Part WHLT-05 Steering Kit for Rudder Springs and Steering Arm Connection

If Base Does Not Have Two Bushings and Grease Fitting, See WHLTWBCNV Conversion Kit to Update to Current Configuration

Note: Alternate Wing Available to Provide Earlier Steering Release.

Release with Standard WHLT-03 = +- 45 Deg  
 Release with Optional WHLT-03A = +-25 Deg (May be Hand Ground to Release from 25 to 50 Deg)

TO SET PRELOAD IN VERTICAL AXLE #7: Be certain #3 & #5 Springs Are Installed. Seat Lower Nut #6 Fully & Insert Cotter Pin #8. Tighten Upper Nut #5 Slowly Until All Freeplay of Springs are removed and Fork #12 No Longer Rotates Freely. Loosen Upper Nut #6 1-4 Locking Features and Install Cotter Pin #8. Fork Should Rotate With Resistance Around Complete Rotation.

<b>MATCO mfg</b>		NOMENCLATURE TAIL WHEEL, 8" PNEUMATIC		PART NUMBER WHLT-8		SCALE 1:4		TOLERANCES (EXCEPT AS NOTED)	
2361 S 1560 West Woods Cross, UT 84087		MATERIAL VARIOUS		DRAWING NO. TAIL/3D-T8		REVISION J		DO NOT SCALE DRAWING	
DRAWN BY George R. Happ		FINISH VARIES		DATE 11/10/2016		CHECKED BY		Est Wt. (lb) 6.92	
				SHEET 1 OF 1		SHEET SIZE A		LINEAR .XX = + .03 .XXX = + .01 ANGULAR + 1/2 CONCENTRIC + .01	