

ITEM #	Part Number	Description	QTY.
1	MSC168P	STRAIGHT FITTING	1
2	MC7H	MC7 HOUSING	1
3	MC7SL	MC-7 SLEEVE	1
4	MSCC0480-055-3000M	SPRING, 3 INCH	1
5	MC-16	SPRING GUIDE	1
6	MSCC0300-026-0440M	SPRING, VALVE	1
7	MCP.688(B)	PISTON, HIGH VOLUME	1
8	MSC2-112	O-RING, BUNA -N	1
9	MSC600-0101-10	SEAL, STAT-O	1
10	MC7-1	SHAFT, MC-7	1
11	MSC600-0101-.375	SEAL, STAT-O	1
12	3000-X75	SNAP RING	1
13	MSC10-24x.62SHCS	SCREW, SOCKET HEAD	2
14	MC6-2	CLAMP	1
15	MSC.31-18X1.25SHSB	BOLT, SHOULDER	1
16	MC7YOKE	YOKE, MC-7	1
17	MCMC7-L	LEVER, MC-7	1
18	MSCAN960-516L	WASHER, AN960	2
19	5100-25	SNAP RING	1
20	MC7-PPIN	PIN, PIVOT	1
21	MSC.25-28NYLOCK	NUT, NYLOCK	1
22	MSCMC7-4	FITTING, VENT	1
23	MSCVC-250-8	COVER, BLEEDER BLK	1

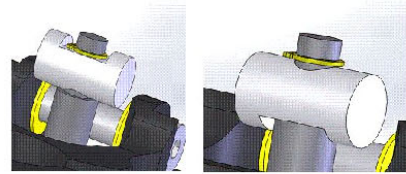

Pivot Pin #20 May be Oriented either way to set lever neutral point

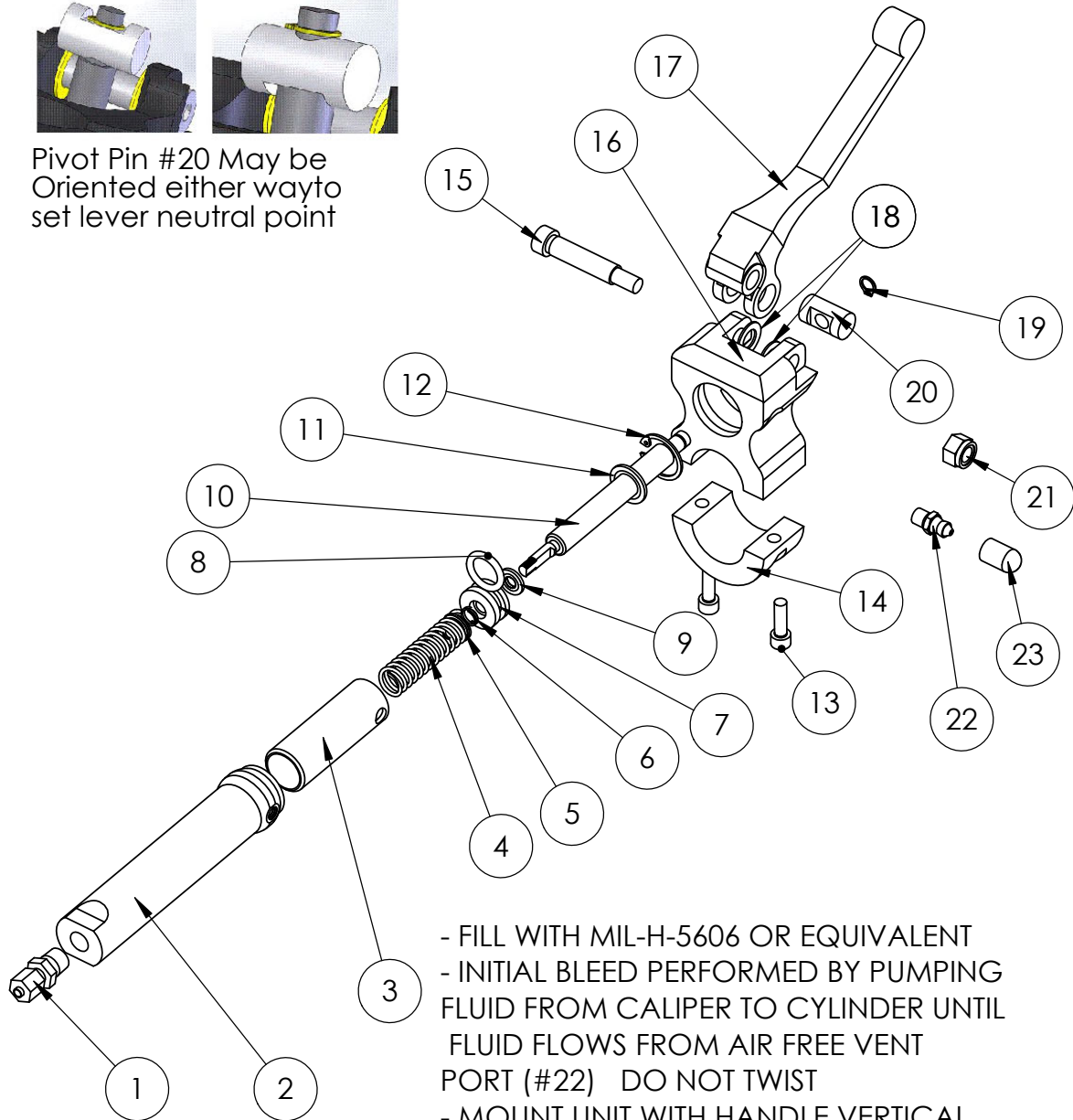

- FILL WITH MIL-H-5606 OR EQUIVALENT
- INITIAL BLEED PERFORMED BY PUMPING FLUID FROM CALIPER TO CYLINDER UNTIL FLUID FLOWS FROM AIR FREE VENT PORT (#22) DO NOT TWIST
- MOUNT UNIT WITH HANDLE VERTICAL
- HOUSING MUST BE FREE TO FLOAT IN YOKE

MATCO mfg



2361 S. 1560 West
Woods Cross, Utah 84087 USA

NOMENCLATURE
HAND OPERATED MASTER CYLINDER

PART NUMBER
MC-7

SCALE
3:8

TOLERANCES
(EXCEPT AS NOTED)

DRAWN BY
Sally Christensen

FINISH
VARIES

DATE
12/15/2021

CHECKED BY

DRAWING NO.

REVISION
F

Est Wt. (lb)
0.75

DO NOT SCALE DRAWING
LINEAR .XX = + .03
.XXX = + .01
ANGULAR ± 1/2
CONCENTRIC ± .01

SHEET 1 OF 1
SHEET SIZE A