

REV B INCORPORATE NORDLOC WASHERS 3/17/11 GRH

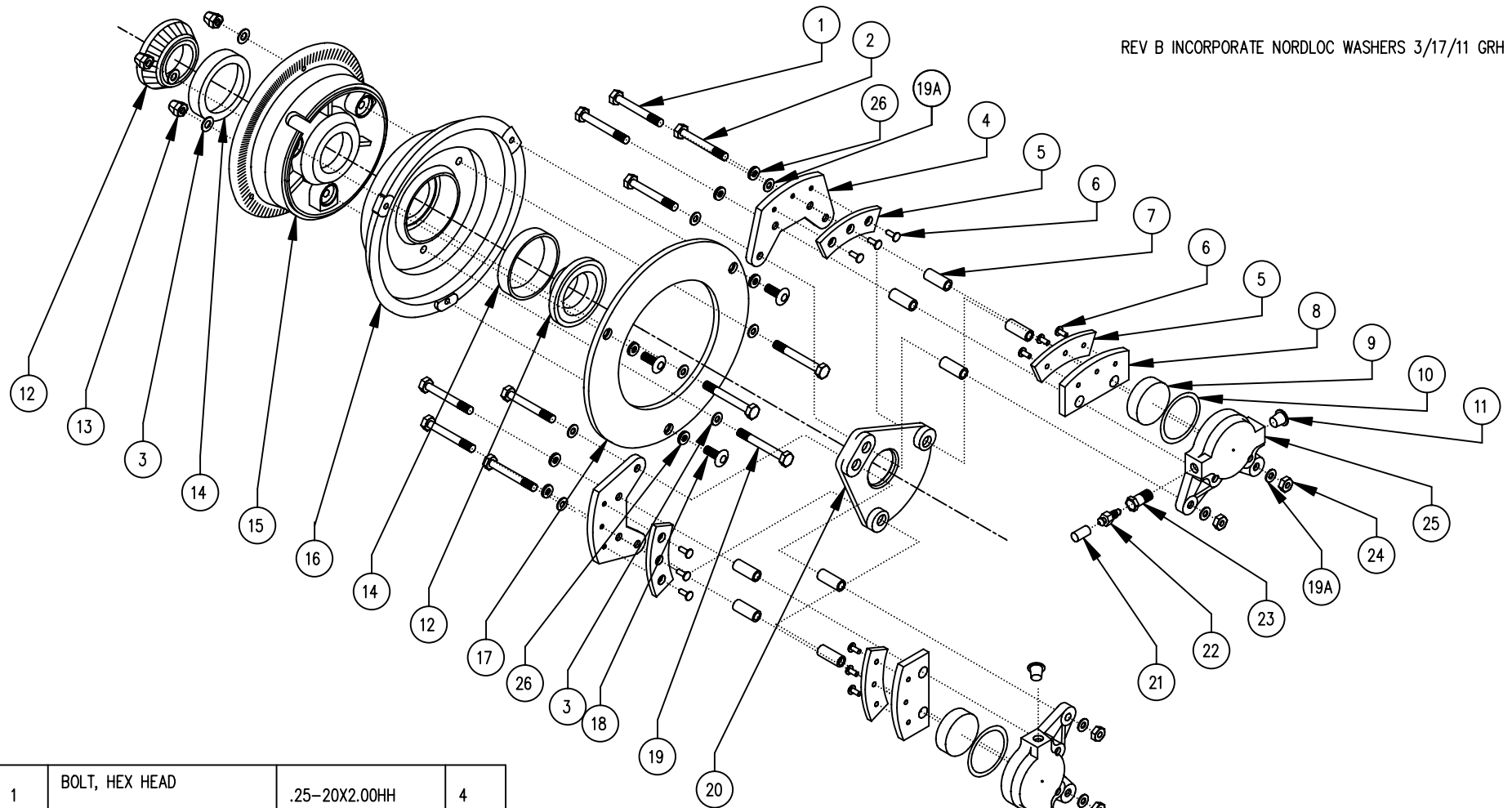

1	BOLT, HEX HEAD	.25-20X2.00HH	4								
2	BOLT	AN4-20A	4	12	ROLLER BEARING, 1.25	LM6700LA	2				
3	WASHER	AN960-416	6	13	FLEX LOCK NUT, .25-28	AN363-428	3	19A	WASHER	AN960-416L	8
4	STATIONARY BRK SHOE, 5/6"	SBS5	2					20	BRAKE PLATE, DUAL	BPD1.38	1
5	LINING, 5/6" BRAKE	M66-106	4	14	BEARING RACE, 1.25	LM67010	2	21	DUST PLUG	.234-.50IL	1
6	BRASS RIVET	4-6	12	15	VALVE HALF, W50, 1.25 BRNG	W50/1.25	1	22	BRAKE BLEEDER VALVE	F6446-007	1
7	SPACER, DUAL/TRIPLE PUCK	BSP6	8	16	BRAKE HALF, W50L, 1.25 BRNG	B50L/1.25	1	23	BRAKE BLEEDER SEAT	BBS(A)	1
8	MOVEABLE BRK SHOE, 5/6"	MBS5	2	17	BRAKE DISC, 5/6"	D5D	1	24	LOCK NUT	.25-28NYLOC	4
9	PISTON, 5/6" BRAKE	PI-1	2	18	SCREW, BUTTON HEAD	.25-20X.75BHCS	3				
10	O-RING BUNA N	2-222	2					25	PUCK HOUSING, 5/6" BRAKE	PH-1A	2
11	CAPLUG	2X	2	19	BOLT	AN4-22A	3	26	WASHER, NORDLOC	NL1/4	7
NO.	PART NAME	INVENTORY NO.	REQ'D	NO.	PART NAME	INVENTORY NO.	REQ'D	NO.	PART NAME	INVENTORY NO.	REQ'D
3W50S75A	MATCO mfg 2361 S 1560 West WOODS CROSS, UT 84087 (801) 335-0582			W50LD			DRAWN BY: GARY P. LANGFORD CHECKED BY:		SCALE: NONE DATE: OCTOBER 4, 1991		REVISION: B